

Waterborne epoxy resin is a type of epoxy resin that is formulated with water as a solvent. It is a two-part system consisting of a resin and a hardener. When mixed together, they undergo a chemical reaction to form a solid, cross-linked polymer. This type of epoxy is known for its low odor, fast curing time, and excellent adhesion to various substrates. It is commonly used in industrial applications, such as flooring, coatings, and adhesives, as well as in consumer products like marine finishes and automotive coatings.

Waterborne epoxy resin is a type of epoxy resin that is formulated with water as a solvent. It is a two-part system consisting of a resin and a hardener. When mixed together, they undergo a chemical reaction to form a solid, cross-linked polymer. This type of epoxy is known for its low odor, fast curing time, and excellent adhesion to various substrates. It is commonly used in industrial applications, such as flooring, coatings, and adhesives, as well as in consumer products like marine finishes and automotive coatings. **Kelin Epoxy Gap Filler** is a high-strength, two-part epoxy resin used for filling gaps and cracks in concrete, stone, and other masonry materials.

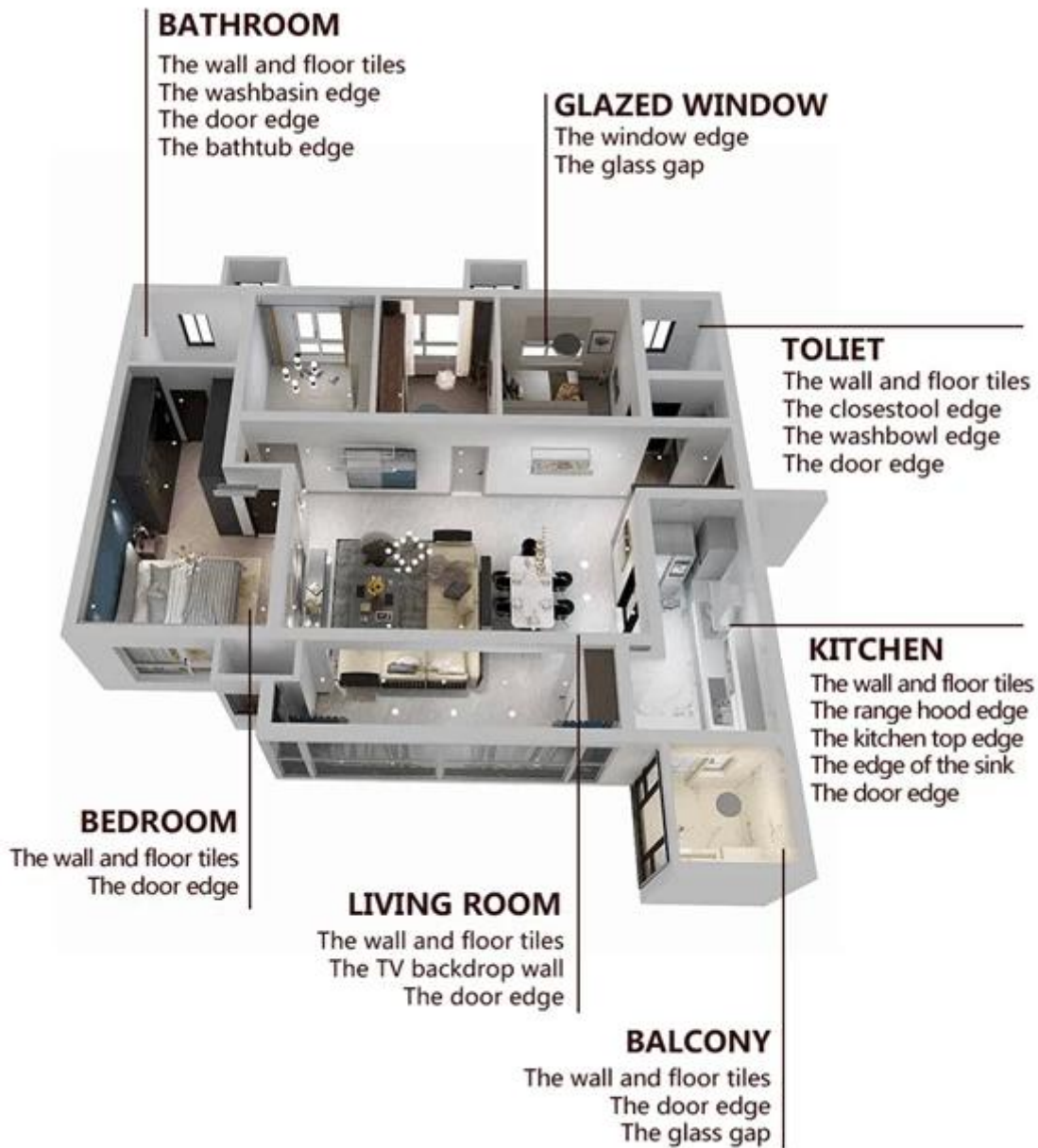

Waterborne epoxy resin is a type of epoxy resin that is formulated with water as a solvent. It is a two-part system consisting of a resin and a hardener. When mixed together, they undergo a chemical reaction to form a solid, cross-linked polymer. This type of epoxy is known for its low odor, fast curing time, and excellent adhesion to various substrates. It is commonly used in industrial applications, such as flooring, coatings, and adhesives, as well as in consumer products like marine finishes and automotive coatings.



□□□□□□□□□□□□□□□□□□□□ □



□□□□□□□□□□



Creaming Machine Line



Testing Machine



Batching Production Line



Cooling Filling



Filling Machine Line



Film-coated Machine



Real Material Stock



Stock

□□□□□□□□

