

Kelin Polyurea 是一种高性能的聚氨酯材料，广泛应用于建筑、工业和交通领域。它具有优异的耐磨性、耐腐蚀性和抗冲击性，能够有效保护各种表面免受损坏。

Polyurea 是一种双组分、无溶剂、快速固化的材料，施工简便，可在潮湿和低温条件下使用。它形成的涂层具有极佳的附着力和弹性，能够适应基材的热胀冷缩。

Subbase 是指用于道路或地基的基层材料，通常由碎石或砂砾组成。它的作用是分散荷载，防止下方土质发生沉降。

" "

China Kelin [Filler Epoxy Gap](#) 是一种用于填补环氧砂浆的专用材料。它由 14 种不同的 R & D 配方组成，能够满足各种工程需求。

Kelin



" "

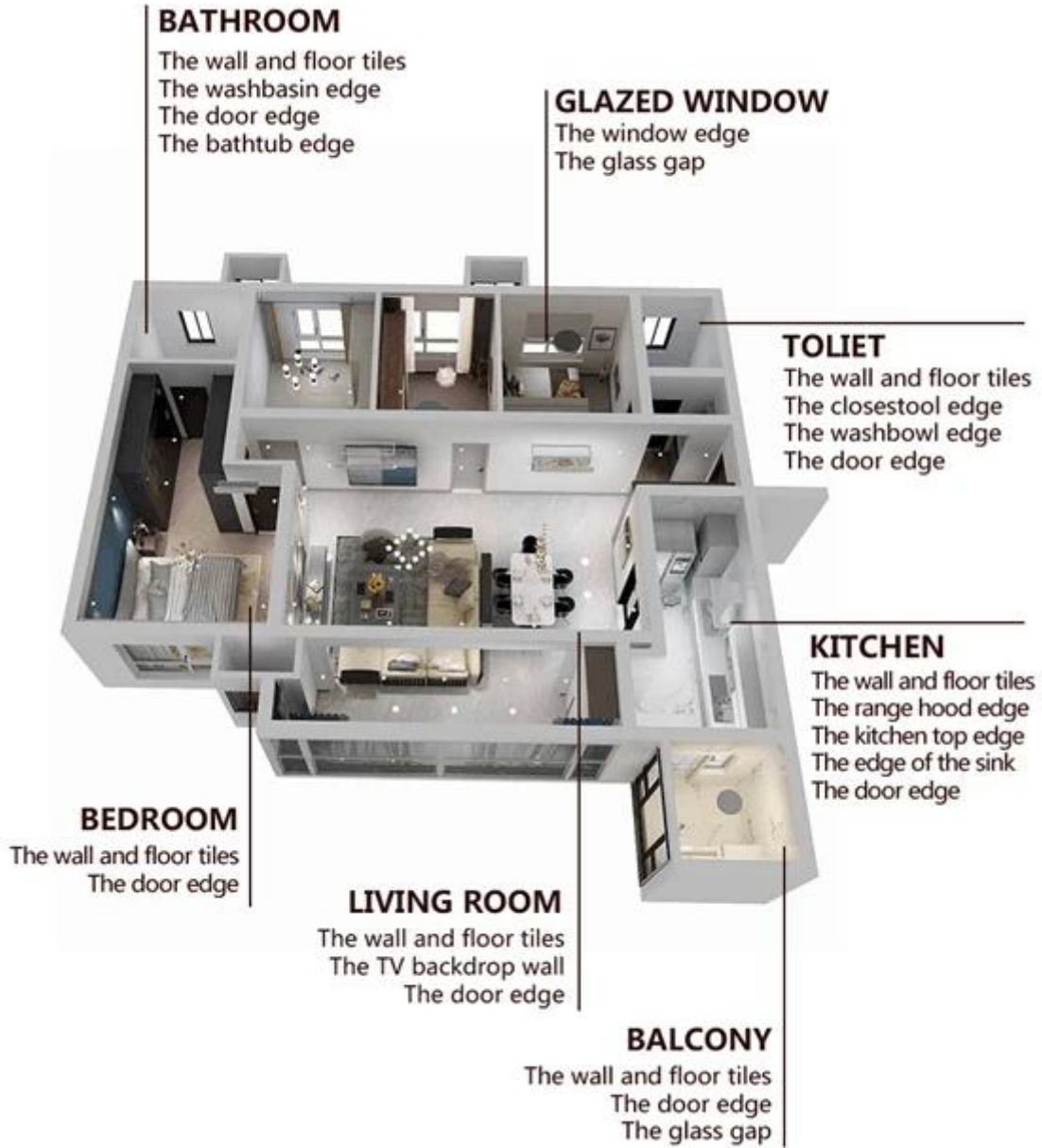



01
Clean the tiles and keep it dry



02
Polish with tile wax except the glazed tile



03
Open & Watch, both sides can extruded meanwhile



04
Screw on the nozzle, put on the grout gun



05
Inclined cut the top of the nozzle in 45°



06
Squeeze out 60-80cm long grout in the forepart



07
Evenly squeeze out the tile agent along the gap



08
Press the grout with professional glue-press tools



09
Don't touch in 4-5 hours and remove excess grout then.



10
Keep the tiles dry in 24 hours



Two Component Caulking Gun

| | | | | | | | |
|--------------|-----------------|-----------|---------------|----------------|--------------|----------------------|--------------|
| | | | | | | | |
| 02 | 03 | 04 | 05 | 06 | 07 | 08 | 09 |
| Cutter Knife | Pointing trowel | Brush | Forming Stick | Perching Knife | Masking Tape | Stainless Steel Ball | Cleaning Awl |





□□□□□□□□□□



Creaming Machine Line



Testing Machine



Batching Production Line



Cooling Filling



Filling Machine Line



Film-coated Machine



Real Material Stock



Stock

□□□□□□□□

