

Kelin
 Chinese Academy of Sciences

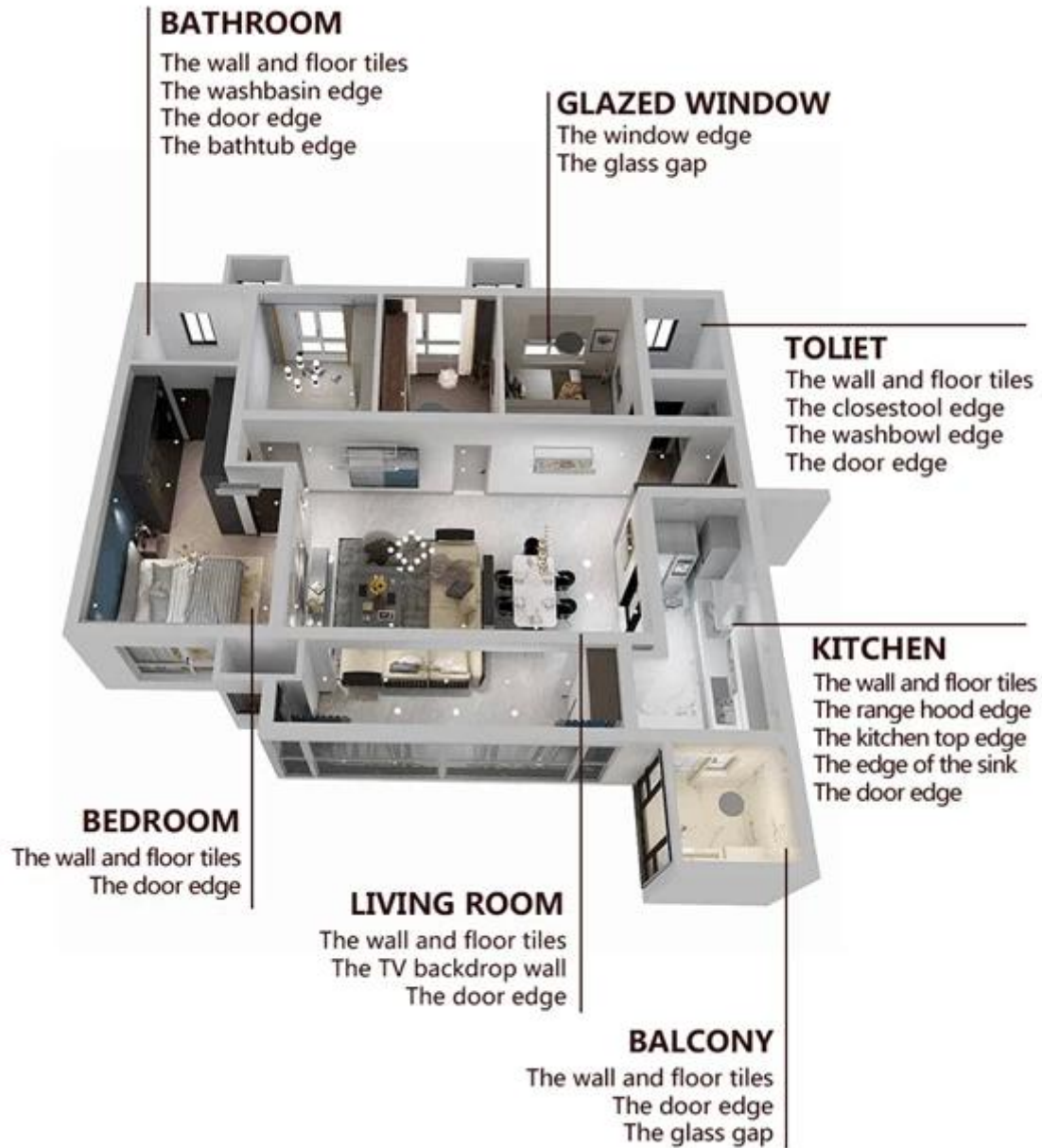



□□□□□□□□□□□□□□□□□□□□□□



01 Clean the tiles and keep it dry



02 Polish with tile wax except the glazed tile



03 Open & Watch, both sides can extruded meanwhile



04 Screw on the nozzle, put on the grout gun



05 Inclined cut the top of the nozzle in 45°



06 Squeeze out 60-80cm long grout in the forepart



07 Evenly squeeze out the tile agent along the gap



08 Press the grout with professional glue-press tools



09 Don't touch in 4-5 hours and remove excess grout then.



10 Keep the tiles dry in 24 hours



Two Component Caulking Gun

02	03	04	05	06	07	08	09
Cutter Knife	Pointing trowel	Brush	Forming Stick	Perching Knife	Masking Tape	Stainless Steel Ball	Cleaning Awl





□□□□□□□□□□



□□□□□□□□□□



□□□□□□□□□□



□□□□□□□□□□



□□□□□□□□□□



□□□□□□□□□□



□□□□□□□□□□



□□□□□□□□□□



□□□□□□□□

□□□□□□□□

