

Kelin Epoxy 係一種高品質之環氧樹脂，其特點是堅固耐用、抗化學腐蝕、易於清潔。Epoxy 係一種由環氧樹脂與固化劑反應而成之熱固性樹脂，其特點是堅固耐用、抗化學腐蝕、易於清潔。Subbase Epoxy Resin 係一種高品質之環氧樹脂，其特點是堅固耐用、抗化學腐蝕、易於清潔。cloud 係一種高品質之環氧樹脂，其特點是堅固耐用、抗化學腐蝕、易於清潔。

此種材料廣泛應用於建築、工業及家居裝修等領域。其優點包括：堅固耐用、抗化學腐蝕、易於清潔、無塵、無縫、美觀大方。此種材料廣泛應用於建築、工業及家居裝修等領域。其優點包括：堅固耐用、抗化學腐蝕、易於清潔、無塵、無縫、美觀大方。



此種材料廣泛應用於建築、工業及家居裝修等領域。其優點包括：堅固耐用、抗化學腐蝕、易於清潔、無塵、無縫、美觀大方。

Gray 1#

Gray 2#

Gray 3#

Gray 4#

Gray 5#

Gray 6#

Gray 7#

Gray 8#

Gray 9#

Cement Gray

Dull Gray

Silver Gray

Metal Gray

Luxury Silver

Glacier White

Calaeatta

Pearl Gold

Slate Gray

Terra Brown

Greyish Green

Yellow Gray

Soft Khaki

Yellowish Brown

Olive Brown

Brownness

Dark Brown

Reddish Brown

Rock Bslack



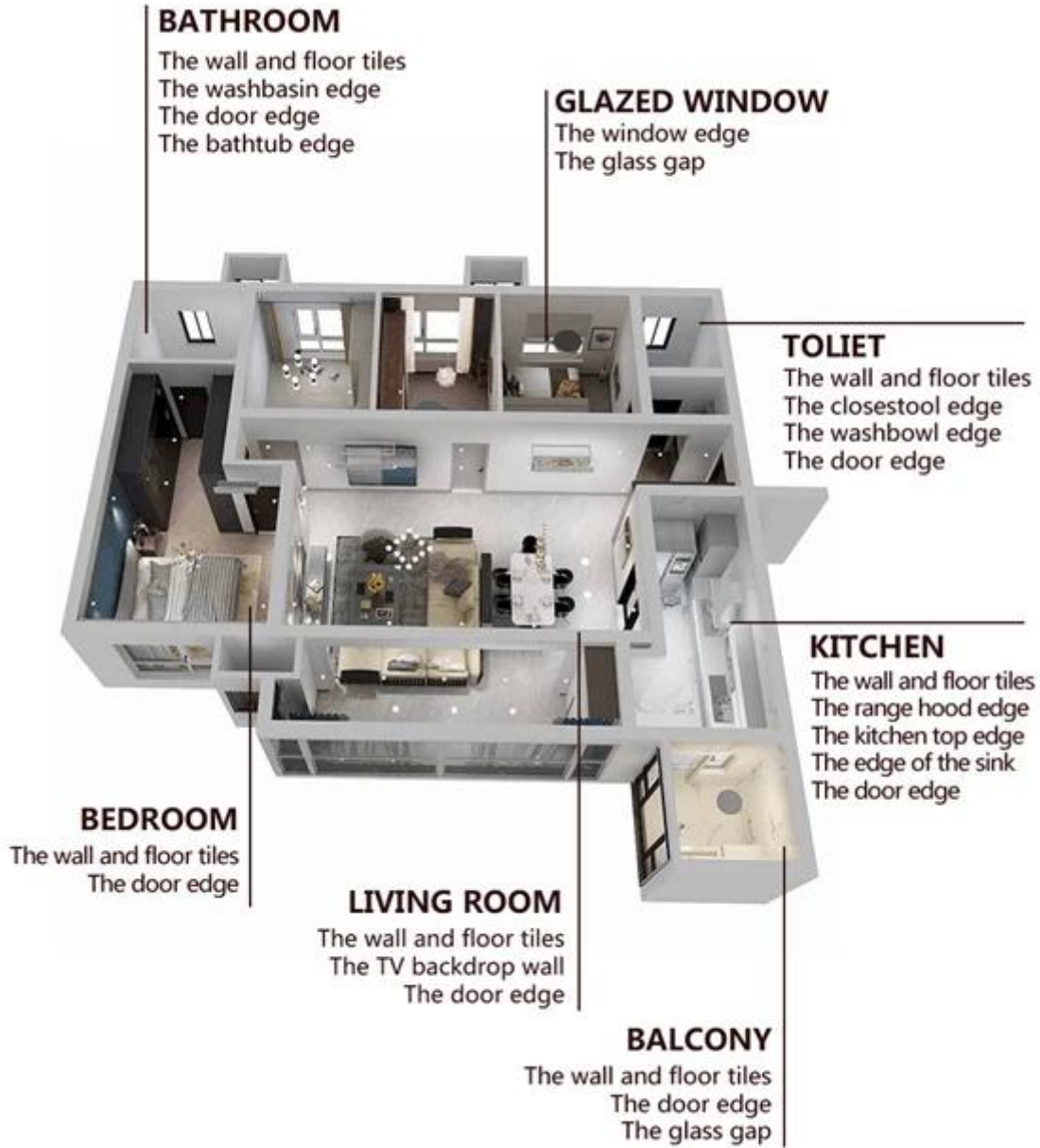

□□□□□□□□□□□□□□□□□□□□ □



01 Clean the tiles and keep it dry



02 Polish with tile wax except the glazed tile



03 Open & Watch, both sides can extruded meanwhile



04 Screw on the nozzle, put on the grout gun



05 Inclined cut the top of the nozzle in 45°



06 Squeeze out 60-80cm long grout in the forepart



07 Evenly squeeze out the tile agent along the gap



08 Press the grout with professional glue-press tools



09 Don't touch in 4-5 hours and remove excess grout then.

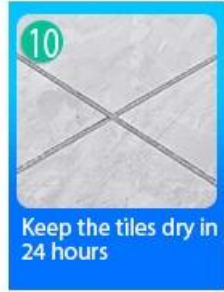

10 Keep the tiles dry in 24 hours

□□



Two Component Caulking Gun

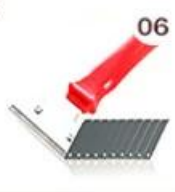

Cutter Knife | Pointing trowel | Brush | Forming Stick | Pointing Knife | Masking Tape | Stainless Steel Ball | Cleaning Awl

□□□□□□□□□□ □□□□□□□□□□



□□□□□□□□□□



Creaming Machine Line



Testing Machine



Batching Production Line



Cooling Filling



Filling Machine Line



Film-coated Machine



Real Material Stock



Stock

□□□□□□□□

