

1. 2. 3. 4. 5. 6. 7. 8. 9. 10. 11. 12. 13. 14. 15. 16. 17. 18. 19. 20. 21. 22. 23. 24. 25. 26. 27. 28. 29. 30. 31. 32. 33. 34. 35. 36. 37. 38. 39. 40. 41. 42. 43. 44. 45. 46. 47. 48. 49. 50. 51. 52. 53. 54. 55. 56. 57. 58. 59. 60. 61. 62. 63. 64. 65. 66. 67. 68. 69. 70. 71. 72. 73. 74. 75. 76. 77. 78. 79. 80. 81. 82. 83. 84. 85. 86. 87. 88. 89. 90. 91. 92. 93. 94. 95. 96. 97. 98. 99. 100.

Kelin Company-Epoxy Tile Grout



Kelin Company-Epoxy Tile Grout



□□□□□□□□□□□□□□□□□□□□□□□□□□□□

BATHROOM

The wall and floor tiles
The washbasin edge
The door edge
The bathtub edge

GLAZED WINDOW

The window edge
The glass gap

TOILET

The wall and floor tiles
The closetool edge
The washbowl edge
The door edge

KITCHEN

The wall and floor tiles
The range hood edge
The kitchen top edge
The edge of the sink
The door edge

BEDROOM

The wall and floor tiles
The door edge

LIVING ROOM

The wall and floor tiles
The TV backdrop wall
The door edge

BALCONY

The wall and floor tiles
The door edge
The glass gap

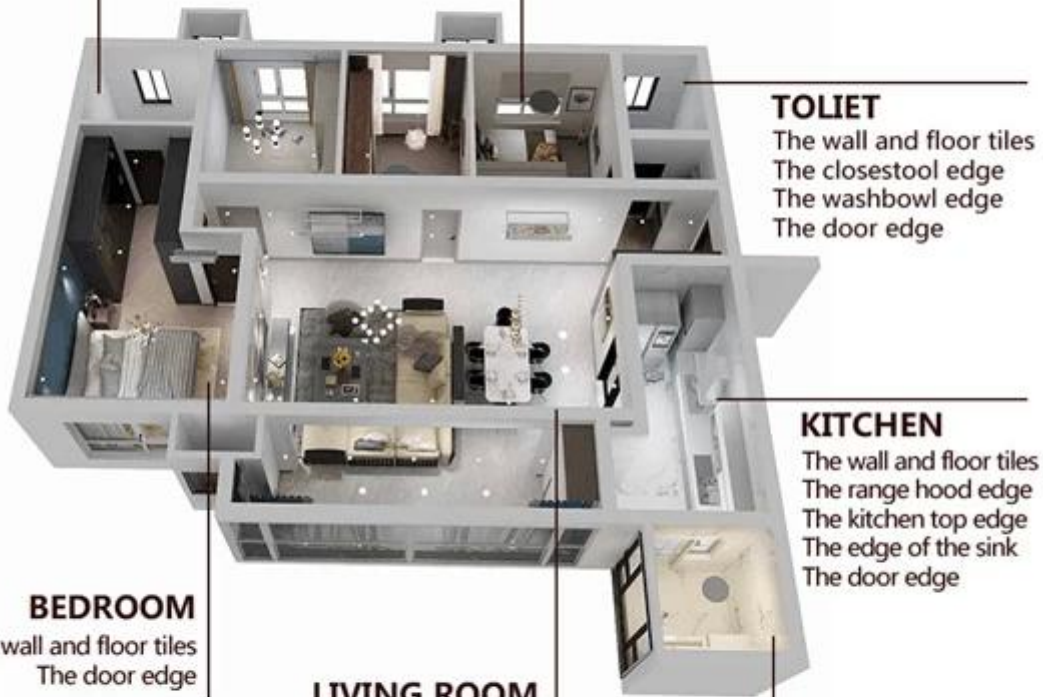

□□□□□□□□□□□□□□□□□□□□□□□□ □



01

Clean the tiles and keep it dry



02

Polish with tile wax except the glazed tile



03

Open & Watch, both sides can extruded meanwhile



04

Screw on the nozzle, put on the grout gun



05

Inclined cut the top of the nozzle in 45°



06

Squeeze out 60-80cm long grout in the forepart



07

Evenly squeeze out the tile agent along the gap



08

Press the grout with professional glue-press tools



09

Don't touch in 4-5 hours and remove excess grout then.



10

Keep the tiles dry in 24 hours



Two Component Caulking Gun

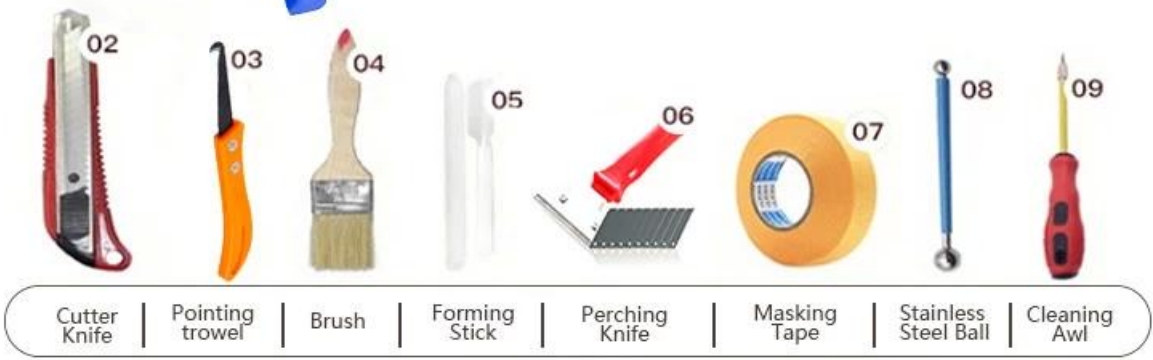



□□□□□□□□□□

| | | | |
|------------|----------------|--------------|----------------|
| ✘ | ✘ | ✘ | ✘ |
| □□□□□□□□□□ | □□□□□□□□□□ | □□□□□□□□□□□□ | □□□□□□□□□□□□□□ |
| ✘ | ✘ | ✘ | ✘ |
| □□□□□□□□□□ | □□□□□□□□□□□□□□ | □□□□□□□□□□□ | □□□□□□□□□□ |

□□□□□□□□

