

Kelin Waterborne Epoxy Gap Filler is a high-performance, water-based epoxy resin used for filling gaps between tiles, grout, and other construction materials. It is designed to provide a durable, long-lasting repair that is resistant to moisture, stains, and wear. The product is easy to apply and dries quickly, making it a popular choice for both professional contractors and DIY enthusiasts. It is suitable for use in a wide range of applications, including bathrooms, kitchens, and living areas.

The product is available in various shades to match your existing tiles and grout. It is also compatible with most types of tiles, including ceramic, porcelain, and natural stone. For more information on the benefits and uses of Kelin Epoxy Gap Filler, please visit our website at [Kelin Epoxy Gap Filler](#).



For more information, please contact our customer service team at 1-800-123-4567.

Gray 1#

Gray 2#

Gray 3#

Gray 4#

Gray 5#

Gray 6#

Gray 7#

Gray 8#

Gray 9#

Cement Gray

Dull Gray

Silver Gray

Metal Gray

Luxury Silver

Glacier White

Calaeatta

Pearl Gold

Slate Gray

Terra Brown

Greyish Green

Yellow Gray

Soft Khaki

Yellowish Brown

Olive Brown

Brownness

Dark Brown

Reddish Brown

Rock Bslack



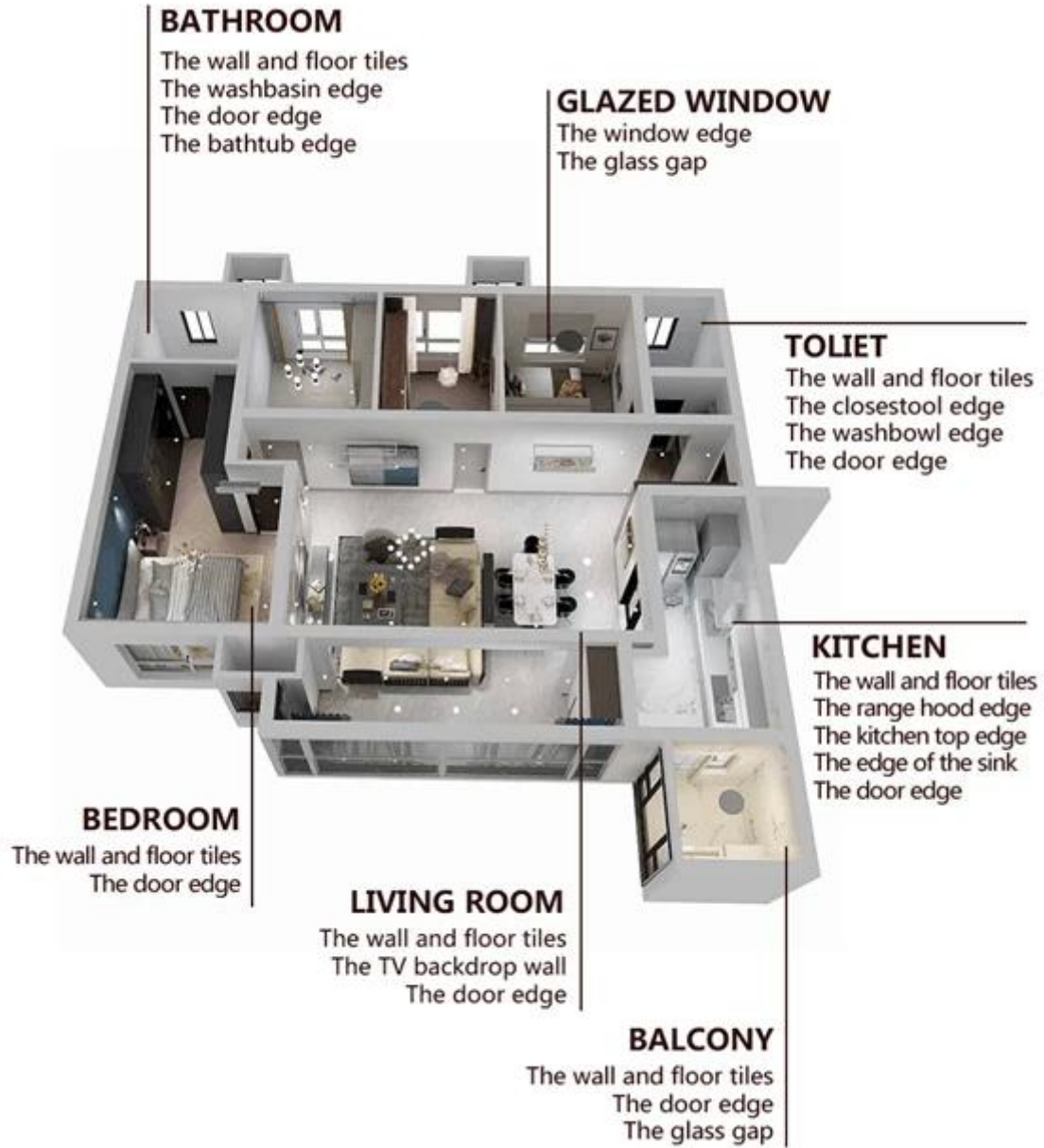

□□□□□□□□□□□□□□□□□□□□□ □

01
Clean the tiles and keep it dry

02
Polish with tile wax except the glazed tile

03
Open & Watch, both sides can extruded meanwhile

04
Screw on the nozzle, put on the grout gun

05
Inclined cut the top of the nozzle in 45°

06
Squeeze out 60-80cm long grout in the forepart

07
Evenly squeeze out the tile agent along the gap

08
Press the grout with professional glue-press tools

09
Don't touch in 4-5 hours and remove excess grout then.

10
Keep the tiles dry in 24 hours

□□□□□□□□□□□□□□□□□□□□



Two Component Caulking Gun

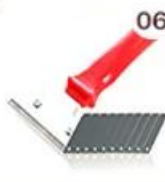

- | | | | | | | | |
|--------------|-----------------|-------|---------------|----------------|--------------|----------------------|--------------|
| Cutter Knife | Pointing trowel | Brush | Forming Stick | Perching Knife | Masking Tape | Stainless Steel Ball | Cleaning Awl |
|--------------|-----------------|-------|---------------|----------------|--------------|----------------------|--------------|

□□□□□□□□ □□□□□□



□□□□□□□□□□



Creaming Machine Line



Testing Machine



Batching Production Line



Cooling Filling



Filling Machine Line



Film-coated Machine



Real Material Stock



Stock

□□□□□□□□

