

Kelin 是一种高性能的陶瓷材料，广泛应用于建筑、工业和家居领域。它具有优异的耐磨性、耐腐蚀性和抗压强度，能够满足各种苛刻的使用环境。此外，Kelin 还具有美观大方、易于清洁和维护的特点，是现代建筑装饰的理想选择。

中国科学院 (Chinese Academy of Sciences) 的研究团队在材料科学领域取得了重要突破，开发出了一种新型高性能陶瓷材料。该材料具有优异的力学性能和热稳定性，为航空航天、能源化工等领域的应用提供了新的可能性。



这种陶瓷材料的应用范围非常广泛，能够满足各种室内装饰的需求。

Gray 1#

Gray 2#

Gray 3#

Gray 4#

Gray 5#

Gray 6#

Gray 7#

Gray 8#

Gray 9#

Cement Gray

Dull Gray

Silver Gray

Metal Gray

Luxury Silver

Glacier White

Calaeatta

Pearl Gold

Slate Gray

Terra Brown

Greyish Green

Yellow Gray

Soft Khaki

Yellowish Brown

Olive Brown

Brownness

Dark Brown

Reddish Brown

Rock Bslack



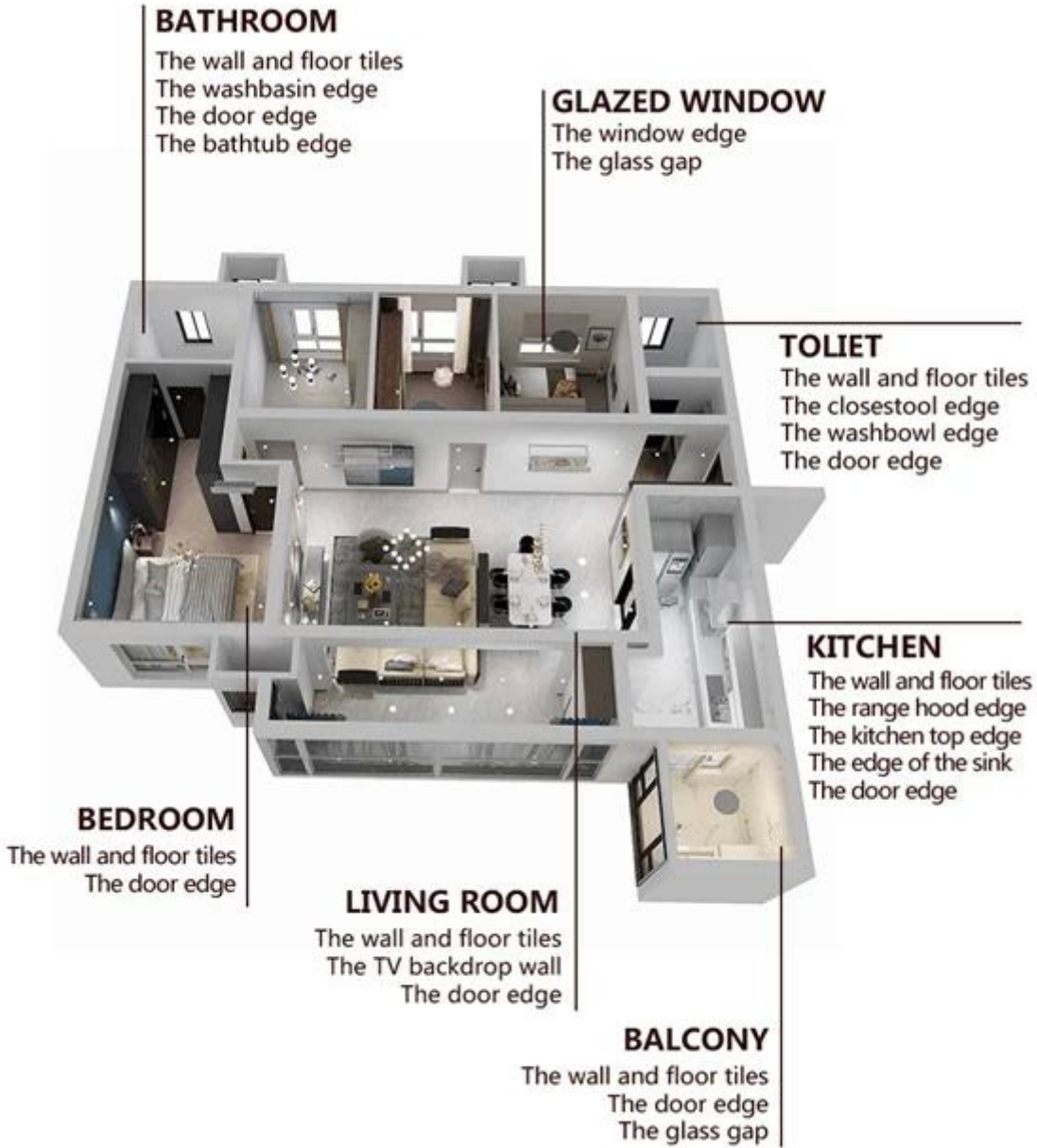



01
Clean the tiles and keep it dry



02
Polish with tile wax except the glazed tile



03
Open & Watch, both sides can extruded meanwhile



04
Screw on the nozzle, put on the grout gun



05
Inclined cut the top of the nozzle in 45°



06
Squeeze out 60-80cm long grout in the forefront



07
Evenly squeeze out the tile agent along the gap



08
Press the grout with professional glue-press tools



09
Don't touch in 4-5 hours and remove excess grout then.



10
Keep the tiles dry in 24 hours

□□□□□□□□□□□□□□□□□□□□□□□□□□□□



Two Component Caulking Gun



- | | | | | | | | |
|--------------|-----------------|-------|---------------|----------------|--------------|----------------------|--------------|
| Cutter Knife | Pointing trowel | Brush | Forming Stick | Perching Knife | Masking Tape | Stainless Steel Ball | Cleaning Awl |
|--------------|-----------------|-------|---------------|----------------|--------------|----------------------|--------------|

□□□□□□□□□□□□□□□□□□□□□□□□□□□□



□□□□□□□□□□



Creaming Machine Line



Testing Machine



Batching Production Line



Cooling Filling



Filling Machine Line



Film-coated Machine



Real Material Stock



Stock

□□□□□□□□

