

Kelin POLYUREA
 subbase
 Chinese Academy of Sciences
 "

Kelin
 14 R&D
 supplier

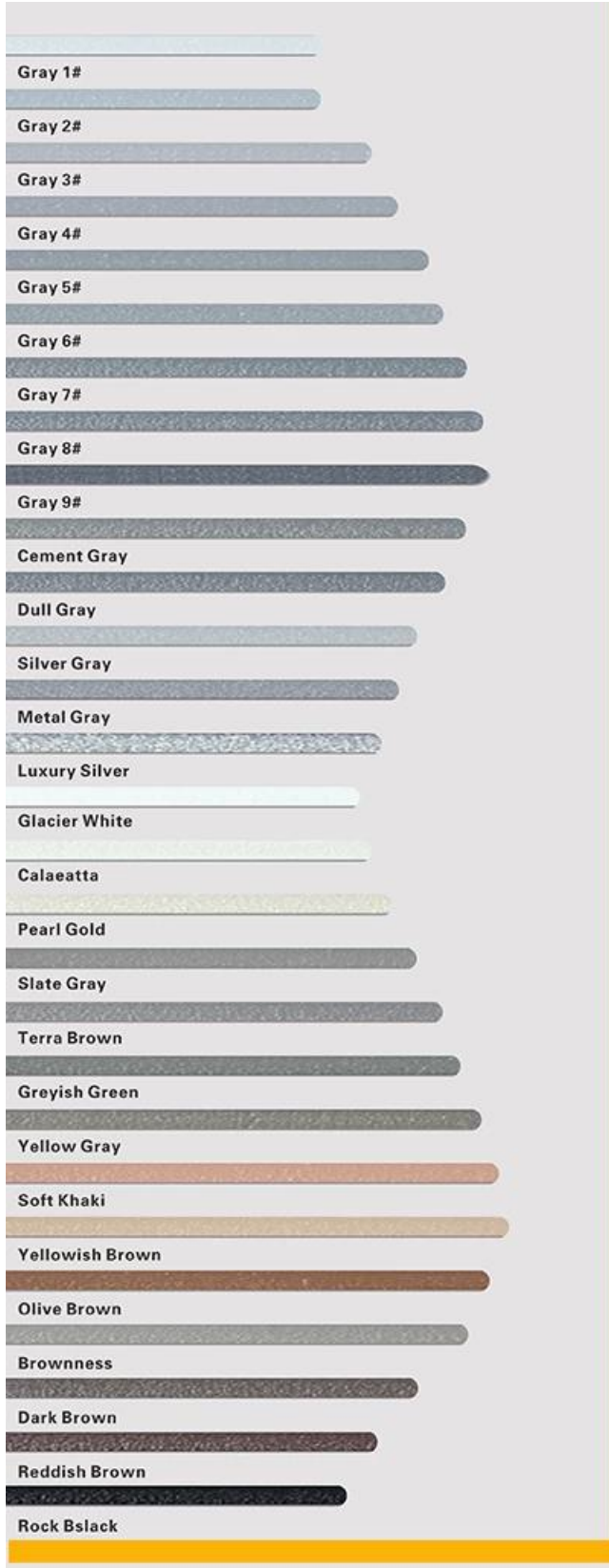

Kelin POLYUREA



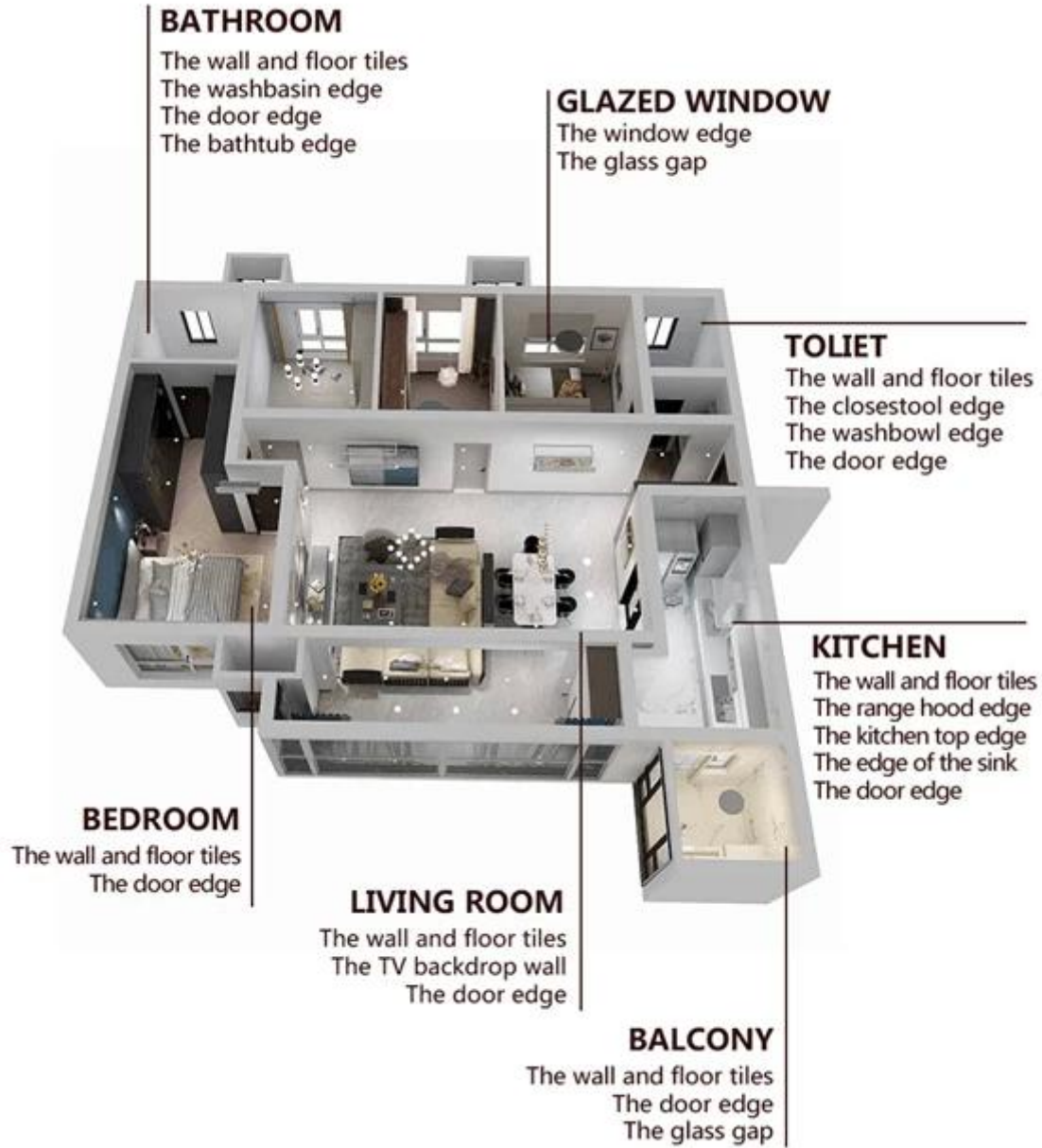



01
Clean the tiles and keep it dry



02
Polish with tile wax except the glazed tile



03
Open & Watch, both sides can extruded meanwhile



04
Screw on the nozzle, put on the grout gun



05
Inclined cut the top of the nozzle in 45°



06
Squeeze out 60-80cm long grout in the forepart



07
Evenly squeeze out the tile agent along the gap



08
Press the grout with professional glue-press tools



09
Don't touch in 4-5 hours and remove excess grout then.



10
Keep the tiles dry in 24 hours

□□□□□□□□□□□□□□□□□□□□□□□□□□□□



Two Component Caulking Gun



- | | | | | | | | |
|--------------------|-----------------------|-------------|---------------------|----------------------|--------------------|----------------------------|--------------------|
| 02
Cutter Knife | 03
Pointing trowel | 04
Brush | 05
Forming Stick | 06
Perching Knife | 07
Masking Tape | 08
Stainless Steel Ball | 09
Cleaning Awl |
|--------------------|-----------------------|-------------|---------------------|----------------------|--------------------|----------------------------|--------------------|

□□□□□□□□□□□□□□□□□□□□□□□□□□□□



□□□□□□□□□□



Creaming Machine Line



Testing Machine



Batching Production Line



Cooling Filling



Filling Machine Line



Film-coated Machine



Real Material Stock



Stock

□□□□□□□□

