

Kelin Epoxy 是环氧树脂的一种，广泛应用于建筑领域。Epoxy 树脂具有优异的粘接性能、机械强度和耐化学腐蚀性。Subbase Epoxy Resin 是一种用于基层处理的环氧树脂，能够有效提高基层的强度和耐久性。此外，环氧树脂还可用于修补混凝土裂缝、制作装饰性涂层等。clund 是一种用于环氧树脂施工的专用工具。kelin 环氧树脂具有多种颜色选择。

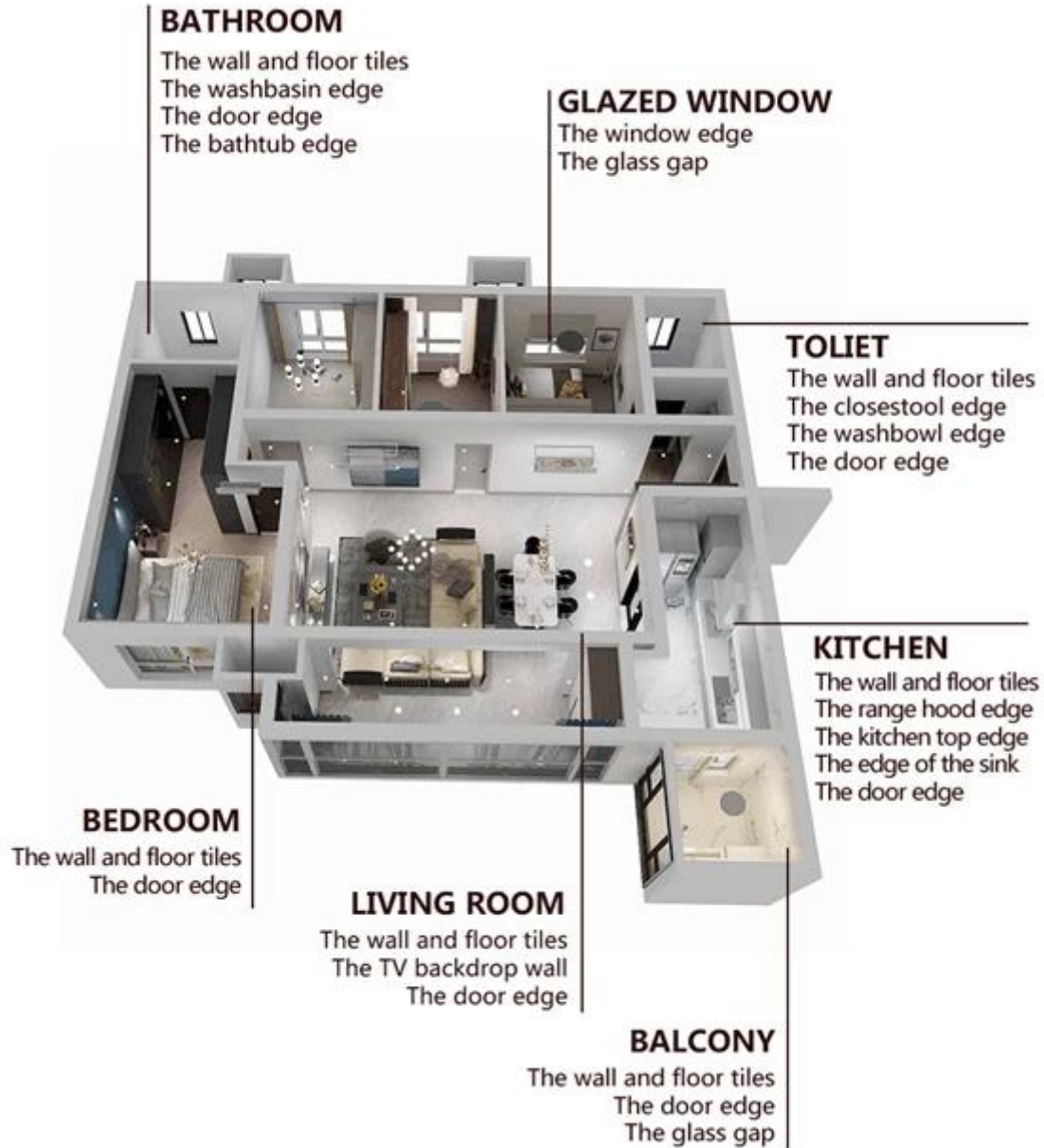

环氧树脂具有多种颜色选择。





□□□□□□□□□□□□□□□□□□□□ □



01

Clean the tiles and keep it dry



02

Polish with tile wax except the glazed tile

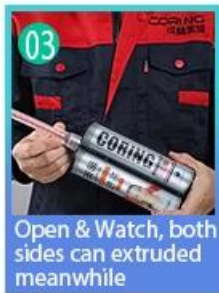

03

Open & Watch, both sides can extruded meanwhile



04

Screw on the nozzle, put on the grout gun



05

Inclined cut the top of the nozzle in 45°



06

Squeeze out 60-80cm long grout in the forepart

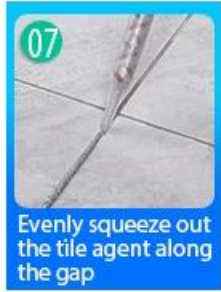

07

Evenly squeeze out the tile agent along the gap



08

Press the grout with professional glue-press tools



09

Don't touch in 4-5 hours and remove excess grout then.

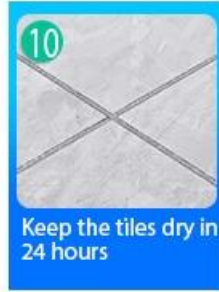

10

Keep the tiles dry in 24 hours

□□□□□□□□□□□□□□□□□□□□□□□□



Two Component Caulking Gun



02



03



04



05

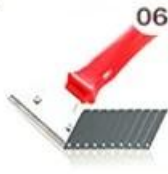

06



07



08



09

Cutter Knife

Pointing trowel

Brush

Forming Stick

Perching Knife

Masking Tape

Stainless Steel Ball

Cleaning Awl

□□□□□□□□□□ □□□□□□

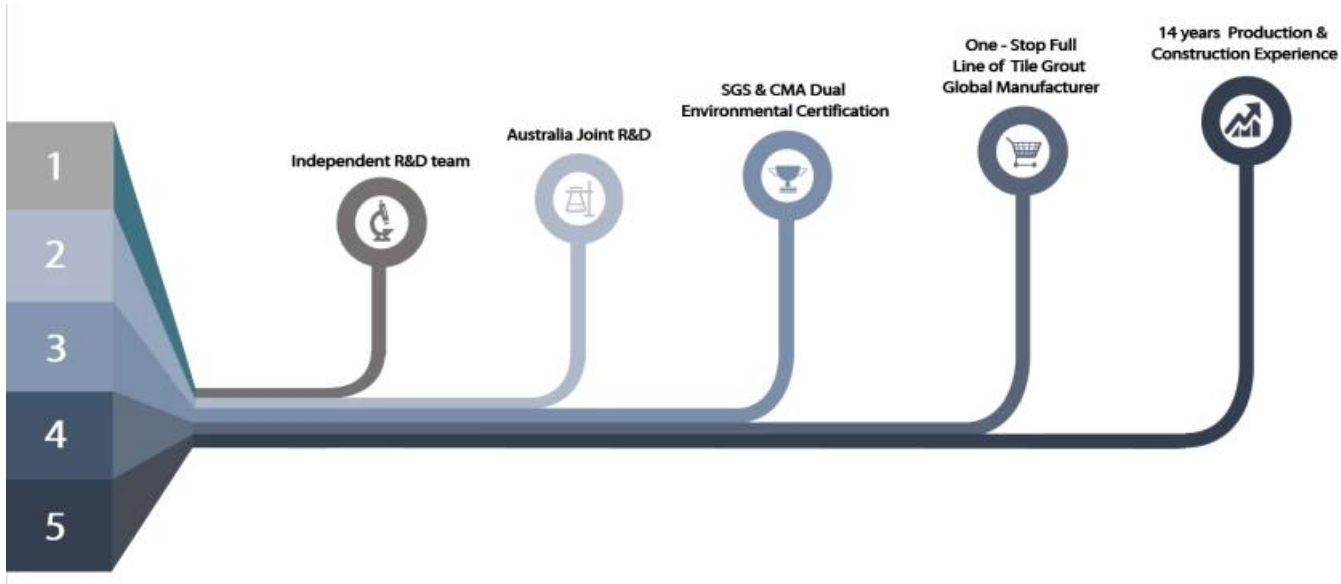

XXXXXXXXXXXX



XXXXXXXXXXXX



XXXXXXXXXXXX



XXXXXXXXXXXX



XXXXXXXXXXXXXXXXXXXX



XXXXXXXXXXXX



XXXXXXXXXXXXXXXXXXXX



XXXXXXXXXXXX



XXXXXXXXXXXX

XXXXXXXXXXXX

