

Kelin 这个公司生产的环氧树脂产品，广泛应用于各种建筑材料的粘接。Epoxy 树脂具有优异的粘接性能和耐久性，能够提供稳定的粘接效果。Subbase Epoxy Resin 是一种专门用于基层处理的环氧树脂，能够有效提高基层的强度和稳定性。clund 则是一种专门用于修补和修复的环氧树脂，能够快速修复各种材料和结构的损伤。

环氧树脂产品广泛应用于各种建筑材料的粘接，如瓷砖、石材、木材等。这些产品能够提供优异的粘接性能和耐久性，确保结构的稳定性和安全性。Epoxy 树脂广泛应用于各种建筑材料的粘接，如瓷砖、石材、木材等。这些产品能够提供优异的粘接性能和耐久性，确保结构的稳定性和安全性。



环氧树脂产品广泛应用于各种建筑材料的粘接，如瓷砖、石材、木材等。这些产品能够提供优异的粘接性能和耐久性，确保结构的稳定性和安全性。

Gray 1#

Gray 2#

Gray 3#

Gray 4#

Gray 5#

Gray 6#

Gray 7#

Gray 8#

Gray 9#

Cement Gray

Dull Gray

Silver Gray

Metal Gray

Luxury Silver

Glacier White

Calaeatta

Pearl Gold

Slate Gray

Terra Brown

Greyish Green

Yellow Gray

Soft Khaki

Yellowish Brown

Olive Brown

Brownness

Dark Brown

Reddish Brown

Rock Bslack



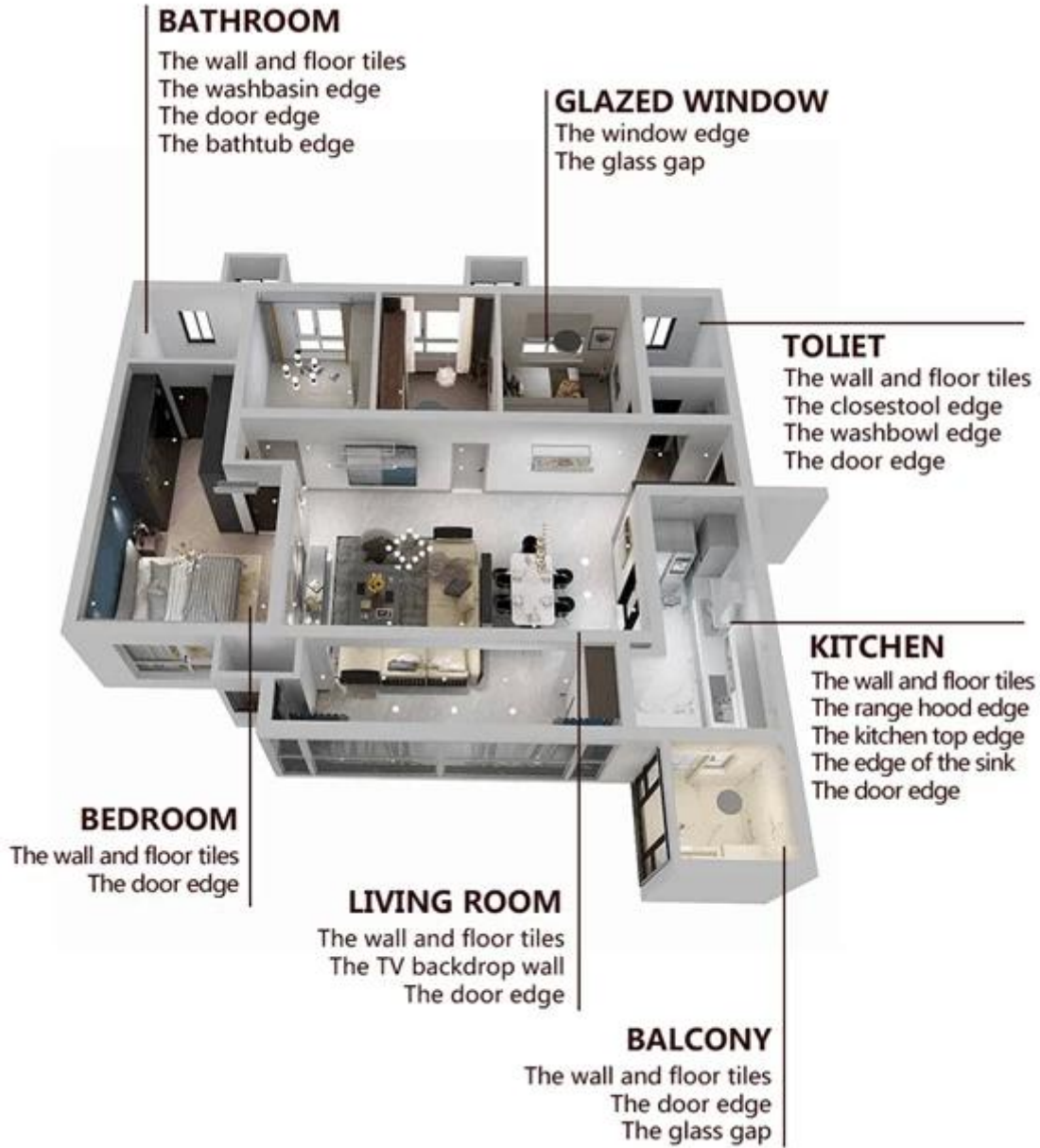

□□□□□□□□□□□□□□□□□□□□ □



Clean the tiles and keep it dry



Polish with tile wax except the glazed tile



Open & Watch, both sides can extruded meanwhile

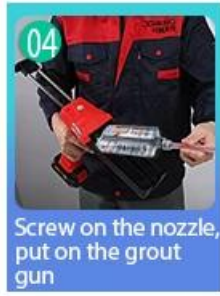

Screw on the nozzle, put on the grout gun



Inclined cut the top of the nozzle in 45°



Squeeze out 60-80cm long grout in the forefront

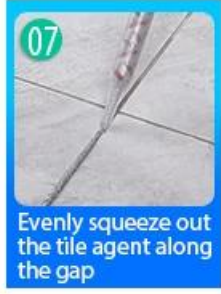

Evenly squeeze out the tile agent along the gap



Press the grout with professional glue-press tools



Don't touch in 4-5 hours and remove excess grout then.



Keep the tiles dry in 24 hours

□□□□□□□□□□□□□□□□□□□□



**Two Component Caulking Gun**



- |                    |                       |             |                     |                      |                    |                            |                    |
|--------------------|-----------------------|-------------|---------------------|----------------------|--------------------|----------------------------|--------------------|
| 02<br>Cutter Knife | 03<br>Pointing trowel | 04<br>Brush | 05<br>Forming Stick | 06<br>Perching Knife | 07<br>Masking Tape | 08<br>Stainless Steel Ball | 09<br>Cleaning Awl |
|--------------------|-----------------------|-------------|---------------------|----------------------|--------------------|----------------------------|--------------------|

□□□□□□□□□□□□□□



□□□□□□□□□□



Creaming Machine Line



Testing Machine



Batching Production Line



Cooling Filling



Filling Machine Line



Film-coated Machine



Real Material Stock



Stock

□□□□□□□□

