

Epoxy Kelin Waterborne RCAN Epoxy Epoxy Resin Subbase

RCAN Epoxy Epoxy Resin Subbase



Wide Application

Gray 1#

Gray 2#

Gray 3#

Gray 4#

Gray 5#

Gray 6#

Gray 7#

Gray 8#

Gray 9#

Cement Gray

Dull Gray

Silver Gray

Metal Gray

Luxury Silver

Glacier White

Calaeatta

Pearl Gold

Slate Gray

Terra Brown

Greyish Green

Yellow Gray

Soft Khaki

Yellowish Brown

Olive Brown

Brownness

Dark Brown

Reddish Brown

Rock Bslack



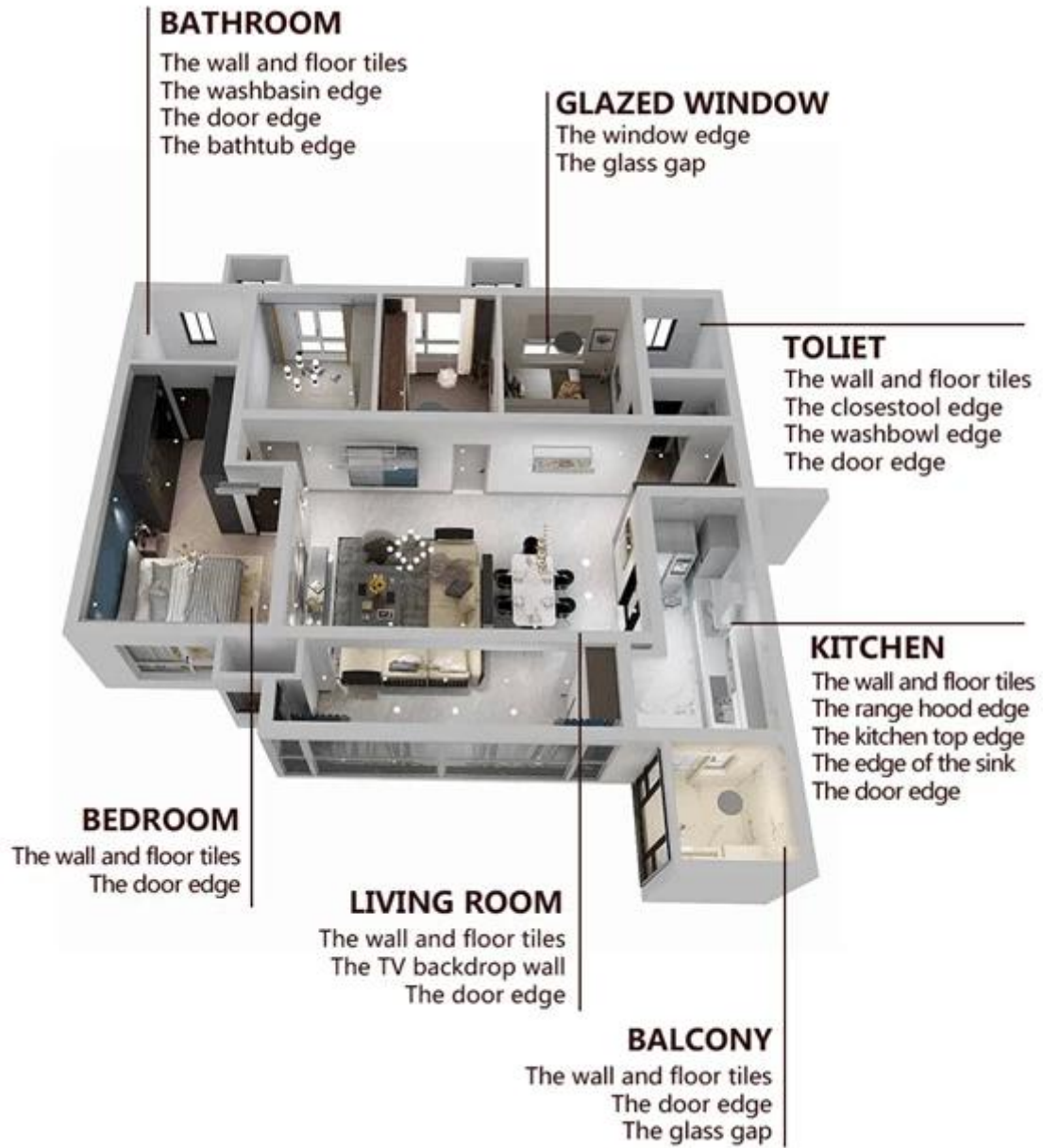

□□□□□□□□□□□□□□□□□□□□ □





01

Clean the tiles and keep it dry



02

Polish with tile wax except the glazed tile



03

Open & Watch, both sides can extruded meanwhile



04

Screw on the nozzle, put on the grout gun



05

Inclined cut the top of the nozzle in 45°



06

Squeeze out 60-80cm long grout in the forefront



07

Evenly squeeze out the tile agent along the gap



08

Press the grout with professional glue-press tools



09

Don't touch in 4-5 hours and remove excess grout then.



10

Keep the tiles dry in 24 hours

□□□□□□□□□□□□□□□□□□□□□□□□□□□□□□□□□□



01



02



03



04



05



06



07

Cutter Knife

Pointing trowel

Brush

Rainbow Scraper

Stirring Knife

The sponge

Scouring Pad

□□□□□□□□□□□□□□□□□□□□□□

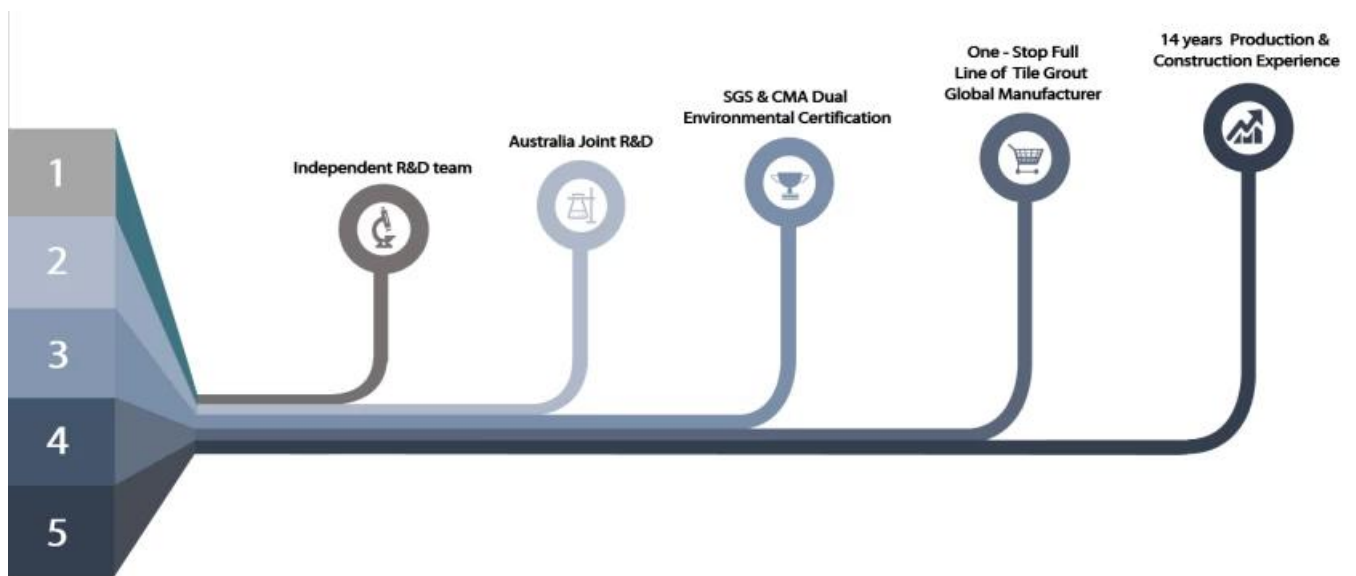

□□□□□□□□□□



Creaming Machine Line



Testing Machine



Batching Production Line



Cooling Filling



Filling Machine Line



Film-coated Machine



Real Material Stock



Stock

□□□□□□□□

