

Kelin Waterborne 係一種環保、無毒、無異味、無揮發性有機化合物 (VOC) 之水性塗料。其具有優異之附著力、耐磨性、耐水性及耐污性。適用於室內外牆面、天花、木器、金屬及玻璃等。其施工簡便，乾燥快，且具良好之透氣性，可防止牆面受潮及霉變。此外，其還具有自潔功能，能抵抗污漬之侵蝕，保持牆面之清潔與美觀。

Kelin Waterborne 係一種環保、無毒、無異味、無揮發性有機化合物 (VOC) 之水性塗料。其具有優異之附著力、耐磨性、耐水性及耐污性。適用於室內外牆面、天花、木器、金屬及玻璃等。其施工簡便，乾燥快，且具良好之透氣性，可防止牆面受潮及霉變。此外，其還具有自潔功能，能抵抗污漬之侵蝕，保持牆面之清潔與美觀。



Kelin Waterborne 係一種環保、無毒、無異味、無揮發性有機化合物 (VOC) 之水性塗料。其具有優異之附著力、耐磨性、耐水性及耐污性。適用於室內外牆面、天花、木器、金屬及玻璃等。其施工簡便，乾燥快，且具良好之透氣性，可防止牆面受潮及霉變。此外，其還具有自潔功能，能抵抗污漬之侵蝕，保持牆面之清潔與美觀。



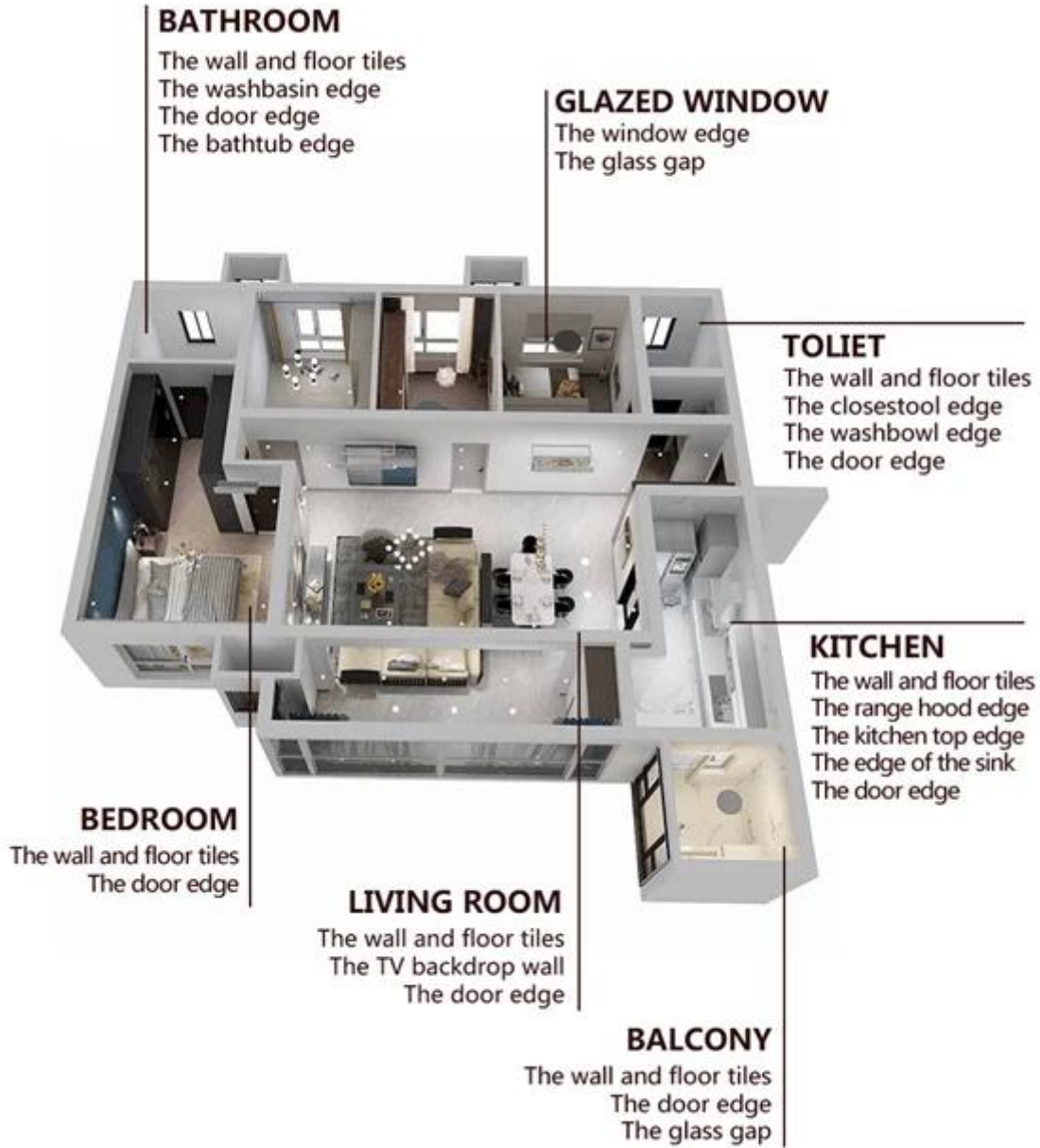

□□□□□□□□□□□□□□□□□□□□□□□□ □



01 Clean the tiles and keep it dry



02 Polish with tile wax except the glazed tile



03 Open & Watch, both sides can extruded meanwhile



04 Screw on the nozzle, put on the grout gun



05 Inclined cut the top of the nozzle in 45°



06 Squeeze out 60-80cm long grout in the forepart

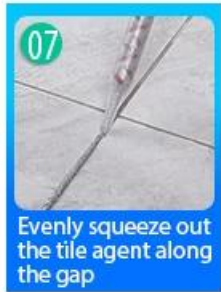

07 Evenly squeeze out the tile agent along the gap



08 Press the grout with professional glue-press tools



09 Don't touch in 4-5 hours and remove excess grout then.











10 Keep the tiles dry in 24 hours

□□□□□□□□□□□□□□□□□□□□□□□□□□



Two Component Caulking Gun

 <p>02</p>	 <p>03</p>	 <p>04</p>	 <p>05</p>	 <p>06</p>	 <p>07</p>	 <p>08</p>	 <p>09</p>
Cutter Knife	Pointing trowel	Brush	Forming Stick	Perching Knife	Masking Tape	Stainless Steel Ball	Cleaning Awl

□□□□□□□□□□ □□□□□□□□



□□□□□□□□□□



Creaming Machine Line



Testing Machine



Batching Production Line



Cooling Filling



Filling Machine Line



Film-coated Machine



Real Material Stock



Stock

□□□□□□□□

