

Subbase Epoxy Resin

Kelin Liquid Sealant S



Gray 1#

Gray 2#

Gray 3#

Gray 4#

Gray 5#

Gray 6#

Gray 7#

Gray 8#

Gray 9#

Cement Gray

Dull Gray

Silver Gray

Metal Gray

Luxury Silver

Glacier White

Calaeatta

Pearl Gold

Slate Gray

Terra Brown

Greyish Green

Yellow Gray

Soft Khaki

Yellowish Brown

Olive Brown

Brownness

Dark Brown

Reddish Brown

Rock Bslack



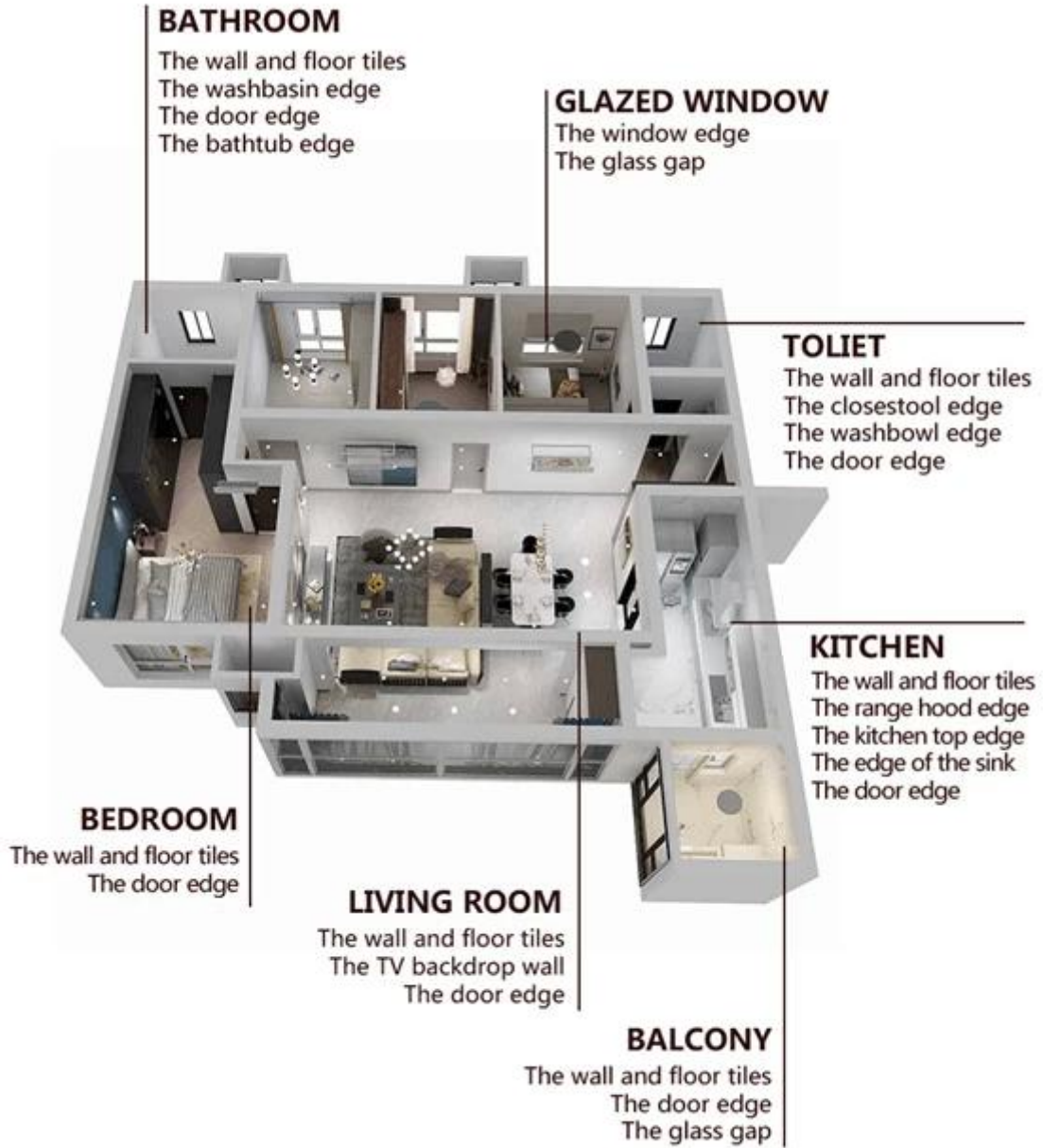



01
Clean the tiles and keep it dry



02
Polish with tile wax except the glazed tile



03
Open & Watch, both sides can extruded meanwhile



04
Screw on the nozzle, put on the grout gun



05
Inclined cut the top of the nozzle in 45°



06
Squeeze out 60-80cm long grout in the forepart

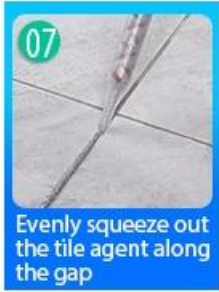

07
Evenly squeeze out the tile agent along the gap



08
Press the grout with professional glue-press tools



09
Don't touch in 4-5 hours and remove excess grout then.

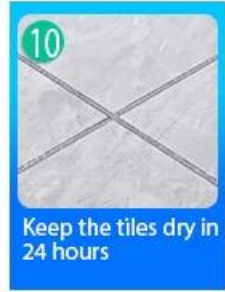

10
Keep the tiles dry in 24 hours

□□□□□□□□□□□□□□□□□□□□□□□□



Two Component Caulking Gun

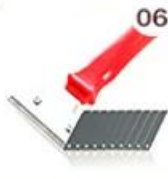

02 Cutter Knife	03 Pointing trowel	04 Brush	05 Forming Stick	06 Perching Knife	07 Masking Tape	08 Stainless Steel Ball	09 Cleaning Awl
--------------------	-----------------------	-------------	---------------------	----------------------	--------------------	----------------------------	--------------------

□□□□□□



□□□□□□□□□□



Creaming Machine Line



Testing Machine



Batching Production Line



Cooling Filling



Filling Machine Line



Film-coated Machine



Real Material Stock



Stock

□□□□□□□□

